

Part Number **HSR-067R** Contact Form A Switch Configuration SPST Rev. D

**Maximum Sensitivity in a Miniature Size**

Features	Advantages
<ul style="list-style-type: none"> <li>Hermetically sealed contacts</li> <li>Switch materials are Lead free and RoHS compliant</li> </ul>	<ul style="list-style-type: none"> <li>Not ESD sensitive</li> <li>Extended operations in extreme environments</li> <li>Excellent historical performance</li> </ul>

**Electrical Specifications**

Power		Watts - maximum	4
Voltage	Switching	VDC - maximum	30
	Breakdown	VDC - minimum	350
Current	Switching	Amp - maximum	0.2
	Carry	Amp - maximum	1.3
Resistance	Initial Contact Resistance	Ohm - maximum	0.20
	Insulation Resistance	Ohm - minimum	1 E11
Capacitance	Contact	pF - typical	0.2
Temperature	Operating	°C	-40 to +125
	Storage	°C	-40 to +200

**Magnetic Specifications**

Pull - In Range		Ampere Turns	10-35
Test Coil		NARM RS-421-A	Coil I

**Physical/Operational Specifications**

Capsule Volume	Excluding Leads	CC - nominal	0.03
Contact Material			Rhodium
Operate Time	Including Bounce	mSeconds - maximum	0.40
Release Time	Including Bounce	mSeconds - maximum	0.10

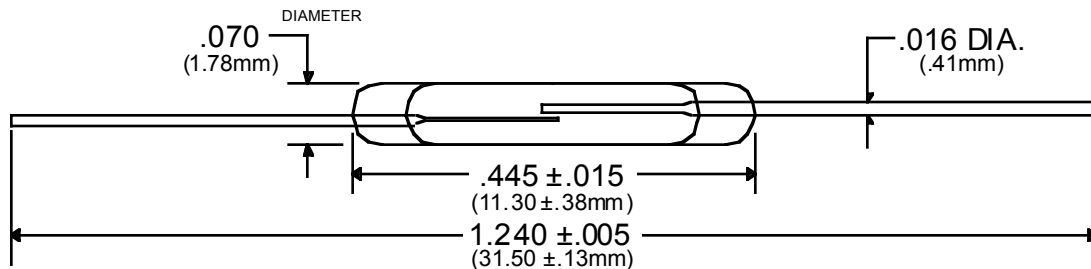

Notes:

- Specifications are not constant across entire magnetic range.
- Customer must exercise care in handling, mounting, lead forming, and cutting to prevent damage to glass capsule and/or switch sensitivity.
- For information or custom configurations about performance, mounting options or packaging, contact our Sales department.
- Information contained hereon is for informational purposes only and should not be deemed as accurate for a specific application. Consult factory for specific application information and/or latest revision.